

APPROVE JUNIOR BRIDGEMEN, INC. LEASE AGREEMENT

Approve Lease Agreement between the Fort Lee Board of Education and Fort Lee Junior Bridgeman, Inc. dated March 24, 2014.

DATED: March 31, 2014

ATTACHMENT

Motion by: Mrs. Holly Morell

Seconded by: Mrs. Esther Han Silver

Motion Passed

Motion Failed

ROLL CALL	AYES	NAYS	ABSENT	ABSTAINED
MRS. ESTHER HAN SILVER	X			
MRS. HOLLY MORELL	X			
MRS. CANDACE ROMBA	X			
MR. DAVID SARNOFF	X			
MR. PETER SUH	X			
MR. JOSEPH SURACE			X	
MR. JEFF WEINBERG			X	
MS. HELEN YOON			X	
MR. YUSANG PARK	X			

LEASE AGREEMENT

This Lease Agreement (the "Agreement") is made as of the 24 day of March, 2014, by and between **FORT LEE BOARD OF EDUCATION**, whose address is 2175 Lemoine Avenue, Fort Lee, New Jersey 07024 ("Board") and **FORT LEE JUNIOR BRIDGEMEN, INCORPORATED**, whose address is PO Box 291, Fort Lee, New Jersey 07024 ("Bridgemen").

RECITALS OF FACT AND PURPOSE:

A. The Board owns facilities known at Lewis F. Cole Middle School ("School"), which is located at 467 Stillwell Avenue, Fort Lee, New Jersey 07024. The School maintains a large recreational facility known as the Dr. Alan W. Sugarman Athletic Facility including multiple athletic fields that have been, and continue to be used by the Bridgemen, as well as other recreational programs in Fort Lee ("Facilities"); and

B. Located on the Facilities is a two-story building hereinafter known as the ("Concession Stand"), which the Bridgemen had constructed as an extension to the first floor of the Concession Stand at their own cost and expense. The Bridgemen currently occupy the second floor of the Concession Stand ("Second Floor").

C. Subsequent to the construction of the extension to the first floor, the Board determined to install bathrooms at the Concession Stand, utilizing the space donated by the Bridgemen for the convenience of spectators. The Board offered, and the Bridgemen accepted, to construct the Second Floor for the use of the Bridgemen.

D. The Board has agreed to permit the Bridgemen to continue to use and occupy the Second Floor, for the period set forth.

NOW, THEREFORE, in consideration of the foregoing premises and of the mutual promises and covenants set forth herein, and other good and valuable consideration, the receipt and sufficiency of which are hereby acknowledged, and intending to be legally bound hereby, the parties agree as follows:

1. Purpose; Term.

1.1 Purpose. Board hereby contracts with Bridgemen to permit the Bridgemen to use and occupy the Second Floor for Bridgemen activities.

1.2 Term. The term of this Agreement shall commence as of July 1, 2013, and end on June 30, 2015 with automatic annual renewals with the right of either party to terminate by giving the other part ninety (90) days written notice of the intent to terminate.

2. Rights and Obligations.

2.1 Improvements. No alterations or improvements shall be made by Bridgemen without the prior written consent of Board.

2.2 Custodial Services. Any custodial services to be provided to the Second Floor shall be upon the mutual agreement of the Board and Bridgemen.

2.3 Hours of Use. Hours of usage during the week and on weekends shall be upon the mutual agreement of the Board and Bridgemen.

2.4 Utilities. Utilities will be paid by the Board of Education.

2.5 No Assignment. Bridgemen shall have no right to assign this Agreement.

2.6 Indemnity. The Board shall not be liable for any damage or injury resulting from any act or omission on the part of Bridgemen or its employees, agents, licensees, invitees, or participants. Bridgemen agrees to defend the Board in, from, and on account of any suit, action, proceeding, or cause, in law or equity, and to indemnify Board and hold it harmless from and against any suit, action, proceeding, cause, judgment, liability, damages, or other expense of any nature, including but not limited to court costs and reasonable attorneys' fees, resulting from any and all claims brought against Bridgemen or its employees, agents, licensees, invitees or students arising out of or related in any manner to the occupancy or use of the Second Floor.

2.7 Access. The Board shall have the right to access and inspect the Second Floor, as necessary, and with the consent of the Bridgemen, which consent shall not be unreasonably withheld.

2.8 Use Fee. The Bridgemen agree to pay Board for use of the Facilities \$1 and other good and valuable consideration.

2.9 Insurance. The Bridgemen shall provide, keep and maintain throughout the term of this Agreement, general casualty and liability insurance coverage in the minimum amount of Two Million Dollars (\$2,000,000) for bodily injury and Five Hundred Thousand Dollars (\$500,000) for property damage. Bridgemen also shall maintain policies of insurance against fire, theft and accidental loss, workers' compensation, unemployment compensation and disability insurance coverage for its employees, and/or agents/volunteers as required by law. The cost of insurance described in this subsection shall be paid by Bridgemen as part of its obligations under this Agreement. The Board shall be named as an additional insured on any such policy.

2.10 Termination. This Agreement may be terminated upon the following events:

(a) By the Board upon 90 days written notice to the other party.

(b) Except as may be otherwise provided in this Agreement, if either party shall fail to perform any of the material duties, obligations or responsibilities to be performed by it pursuant to this Agreement and such default shall continue for a period of ten (10) days after written notice describing the claimed default has been given by the other party, the party serving such notice may terminate this Agreement immediately upon written notice. Such rights of termination shall be in addition to and without limitation upon the other rights of the party serving the notice of termination.

(c) Immediately at any time that Bridgemen fails to maintain the insurance providing all of the coverage required by paragraph 2.9 of this Agreement and such insurance is not reinstated within ten (10) days of receipt of notice from the Board, provided that the failure to have maintained the applicable insurance does not result in any gap in coverage or otherwise adversely affect Board.

2.11 Notices. Whenever, under the terms of this Agreement, written notice is required or permitted to be given by any party to any other party, such notice shall be deemed to have been sufficiently given and effective when deposited in the United States Mail, in a properly stamped envelope, certified or registered mail, return receipt requested, delivered personally or sent via overnight courier, addressed to the party to whom it is to be given, at the address hereinafter set forth. Either party hereto may change its respective address by written notice.

2.12 Compliance. The parties agree that the Bridgemen will comply with laws, Board policies and regulations governing the use of school-owned real property during the term of occupancy.

2.13 Acknowledgement. The Bridgemen and the Board acknowledge that the use of the Facility is concurrent with other entities use of the Facility. Those other entities include local recreation programs, the Borough of Fort Lee and the High School and Middle School athletic programs. The Bridgemen have equal access to the fields and will not be given special accommodations in order to run its program. The Board's athletic programs will always have the use of the Facility for Board operated athletic programs.

3. Entire Agreement. This Agreement contains the sole and entire agreement between the parties with respect to the subject matter hereof and shall supersede all prior and contemporaneous agreements, negotiations, promises or understandings between the parties, whether oral or written, relating to the subject matter hereof. The parties acknowledge and agree that they have not made any representations with respect to the subject matter of this Agreement, or any representations inducing the execution and delivery hereof except for such representations as are specifically set forth herein.

4. Miscellaneous.

9.1 Modifications. This Agreement may not be amended or modified in any manner except by an instrument in writing signed by the parties.

9.2 Governing Law. This Agreement shall be governed by and construed in accordance with the laws of the State of New Jersey, without regard to choice of law principles, in which jurisdiction this Agreement is hereby made.

9.3 Severability; Waiver. The provisions of this Agreement are severable and the invalidity or unenforceability of any provision shall not affect the validity of this Agreement or any other provision. The waiver by either party of a breach of any provisions contained herein shall not be construed as a waiver of any succeeding breach of such provision or of the waiver of the provision itself.

9.4 Counterparts. The Agreement may be executed in separate counterparts by each of the parties. A facsimile signature shall be considered an original for the purposes of this document.

IN WITNESS WHEREOF, the parties hereto have executed this Agreement on the date and year first above written.

WITNESS: FORT LEE BOARD OF EDUCATION

_____ By: _____
Board Secretary Name: _____
Title: _____

WITNESS: FORT LEE JUNIOR BRIDGEMEN, INC.

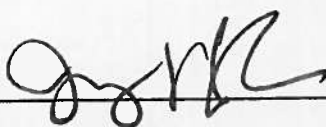
 By:  _____
Name: Joseph V Tripodi
Title: Vice President

BUILDINGS & GROUNDS COMMITTEE

#1B&G

RESOLUTION NO. 26171

APPROVE CHANGE OF USE FOR AUTISTIC STUDENTS

WHEREAS, there exists a need for an additional classroom for autistic students, and

WHEREAS, there is not a classroom available to accommodate this class, and

WHEREAS, there is space available in School #1 originally designated as a Computer Lab, and

WHEREAS, use of this space requires the Executive County Superintendent's approval to be used as a classroom for autistic students, and

NOW, THEREFORE, BE IT RESOLVED, that the Fort Lee Board of Education approves the Change of Use Application to allow use of the space at School #1 for a classroom for autistic students, and

BE IT FURTHER RESOLVED, that the Fort Lee Board of Education also approves a request to establish the Special Education Program in accordance with the State Department of Education regulations.

DATED: March 31, 2014
ATTACHMENT

Motion by: Mrs. Holly Morell

Seconded by: Mrs. Esther Han Silver

Motion Passed

Motion Failed

ROLL CALL	AYES	NAYS	ABSENT	ABSTAINED
MRS. ESTHER HAN SILVER	X			
MRS. HOLLY MORELL	X			
MRS. CANDACE ROMBA	X			
MR. DAVID SARNOFF	X			
MR. PETER SUH	X			
MR. JOSEPH SURACE			X	
MR. JEFF WEINBERG			X	
MS. HELEN YOON			X	
MR. YUSANG PARK	X			

12 ft.

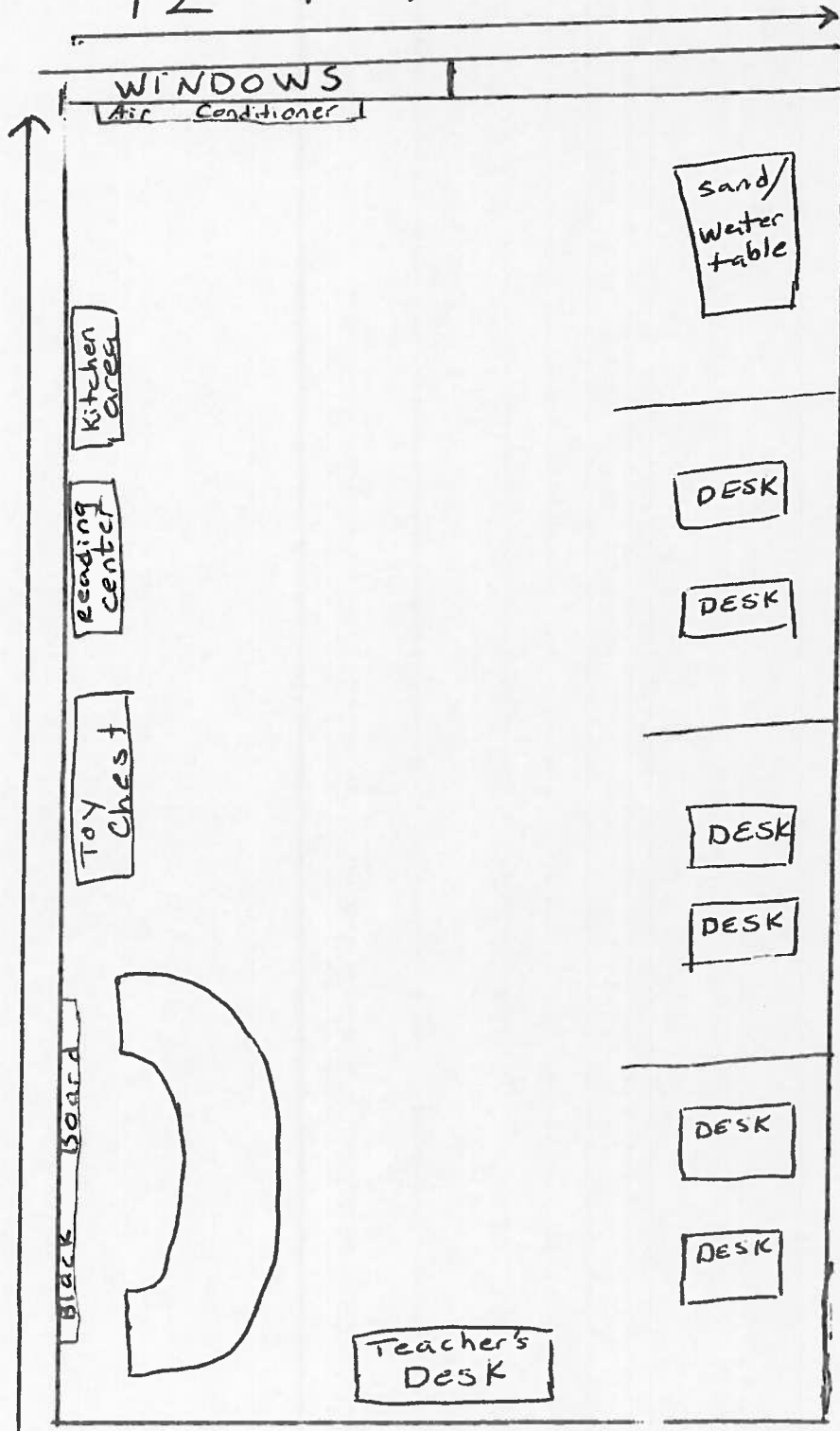

29 ft.

#4

The door swings in

Furniture: Teacher's Desk

File cabinet

6 student tables/desks

Kidney Table

Dividers

Sand/Water Table

Toy Chest

Teacher Chair/Student Chairs

Carpet

New Jersey State Department of Education
Bergen County Office of Education

Request to Establish or Eliminate a Special Education Program or Service

Complete **both** sides of this form and send to the county office of education for review and approval

District: Fort Lee Public School District School: Fort Lee Early Childhood Center

Date: February 24, 2014

Check One: Establish a Program/Service Eliminate a Program/Service

Check Type of Program:

Preschool/Elementary Resource Program:

- Pull/out, support
- Pull/out, replacement
- In-class, support
- In-class, replacement
- Team Teaching Model

Secondary Resource Program¹:

- Pull/out, support
- Pull/out, replacement
- In-class, support
- In-class, replacement

Elementary Special Class Program:

- Auditory Impairments
- Autism
- Behavioral Disabilities
- Cognitive Impairments, mild
- Cognitive Impairments, moderate
- Cognitive Impairments, severe
- Learning/ Language Disabilities, mild/moderate
- Learning/ Language Disabilities, severe
- Multiple Disabilities
- Preschool Disabilities ABA (New)
- Visual Impairments
- Secondary Special

Secondary Special Class Program²:

- Auditory Impairments
- Autism
- Behavioral Disabilities
- Cognitive Impairments, mild
- Cognitive Impairments, moderate
- Cognitive Impairments, severe
- Learning/ Language Disabilities mild/moderate
- Learning/ Language Disabilities, severe
- Multiple Disabilities
- Visual Impairments

Other program/service, please specify: _____

Note: Each newly proposed resource program, special class program and service must be located in a space that has been approved by the County Superintendent of Schools. Forms for substandard use are available in the county office. Facility approval must be obtained before approval of the request to establish a new program can be granted.

¹ Secondary resource programs are located in schools that contain any combination of grades 6 through 12, where the organizational structure is departmentalized for general education students.

² Secondary special class programs are located in schools that contain any combination of grades 6 through 12, where the organizational structure is departmentalized for general education students.

On a separate page, describe your request based on the following corresponding criteria/questions.

To Establish a New Program/Service

1. Document the unmet student needs that will be addressed by the proposed program.
2. Describe the proposed program and explain how it will meet student needs:
 - a. Identify the age range and number of students to be served.
 - b. How will the Core Curriculum Content Standards be addressed?
 - c. How does this program address least restrictive environment?
 - d. What opportunities will be available for interaction with non-disabled peers?
 - e. State the number of professional and paraprofessional staff. For paraprofessional staff submit the locally developed job description and standards for approval (N.J.A.C. 6:11-4.6(c)).

To Eliminate a Program/Service

1. Provide a rationale for eliminating the program/service.
2. If the elimination of the special education program/service will result in a change to one or more students' current IEP(s), describe how the students' needs will be met.

 I assure that the attached proposal to establish a new program/service is in accordance with New Jersey Administrative Code (N.J.A.C.) 6A:14, Special Education and N.J.A.C. 6A:26, Educational Facilities. (Attach the Board Resolution approving the establishment of the new program.)

Board Approval Date: _____

Signed: _____

(Chief School Administrator)

 I assure that any change in a student's program/placement necessitated by eliminating the special education program/service described in the attached proposal will be implemented in accordance with N.J.A.C. 6A:14, Special Education. (Attach the Board Resolution approving the elimination of the program/service.)

Board Approval Date: _____

Signed: _____

(Chief School Administrator)

Approved _____ Denied _____
Signed: _____ Date _____ (County Supervisor of Child Study)

***Establish a New Program
Elementary School/Autistic Preschool***

2014 Only

Fort Lee Public School District administration is interested in opening a new autistic preschool class to allow the enrollment to increase to six autistic preschool students for the remainder of the 2014 school year. Currently, we have a large number of student coming from Early Intervention and we have no space to accommodate the change in enrollment.

This class will be temporarily housed in an Elementary School, in an Art classroom which will be separated by a divider. This class is for students with a diagnosis of Autism. The students require a full day based upon their needs and requirement for ABA instruction and a host of special education supports and related services. Students will receive a minimum of 90 minutes of ABA daily incorporated into their program. The class ratio established for this class is 6 students with one teacher and a minimum of two instructional aides with a ratio of 2 – 1.

Students enrolled in this class will be educated in the least restrictive environment as per N.J.A.C. 6A:14-4.2 (a). These students will not be placed in an out of district program (public or private).

- Students will be educated within a community setting in their own neighborhood school with other students who are not disabled.
- They will be provided the opportunity to be included with their non-disabled peers
- Students will be able to receive their related services based upon their IEP needs within their school.
- The students will be educated is an elementary school located within Fort Lee

This class is being opened due to the large number of students who are coming to the Fort Lee Public School District who are diagnosed with Autism and need to be placed by their third birthday as per N.J.A.C. 6A: Chapter 14 Special Education (3.3) into preschool from Early Intervention Services. The school is a few blocks from the Fort Lee Early Childhood Center. Students are already enrolled on School 1 PowerSchool roster.

New Jersey State Department of Education
Bergen County Office of Education

Request to Establish or Eliminate a Special Education Program or Service

Complete **both** sides of this form and send to the county office of education for review and approval

District: Fort Lee Public School District School: School 1

Date: February 24, 2014

Check One: Establish a Program/Service Eliminate a Program/Service

Check Type of Program:

Preschool/Elementary Resource Program:

- Pull/out, support
- Pull/out, replacement
- In-class, support
- In-class, replacement
- Team Teaching Model

Secondary Resource Program¹:

- Pull/out, support
- Pull/out, replacement
- In-class, support
- In-class, replacement

Elementary Special Class Program:

- Auditory Impairments
- Autism
- Behavioral Disabilities
- Cognitive Impairments, mild
- Cognitive Impairments, moderate
- Cognitive Impairments, severe
- Learning/ Language Disabilities, mild/moderate
- Learning/ Language Disabilities, severe
- Multiple Disabilities
- Preschool Disabilities
- Visual Impairments

Secondary Special Class Program²:

- Auditory Impairments
- Autism
- Behavioral Disabilities
- Cognitive Impairments, mild
- Cognitive Impairments, moderate
- Cognitive Impairments, severe
- Learning/ Language Disabilities, mild/moderate
- Learning/ Language Disabilities, severe
- Multiple Disabilities
- Visual Impairments
- Secondary Special Class (taught by regular education teacher)

Other program/service, please specify: _____

Note: Each newly proposed resource program, special class program and service must be located in a space that has been approved by the County Superintendent of Schools. Forms for substandard use are available in the county office. Facility approval must be obtained before approval of the request to establish a new program can be granted.

¹ Secondary resource programs are located in schools that contain any combination of grades 6 through 12, where the organizational structure is departmentalized for general education students.

² Secondary special class programs are located in schools that contain any combination of grades 6 through 12, where the organizational structure is departmentalized for general education students.

On a separate page, describe your request based on the following corresponding criteria/questions.

To Establish a New Program/Service

1. Document the unmet student needs that will be addressed by the proposed program.
2. Describe the proposed program and explain how it will meet student needs:
 - a. Identify the age range and number of students to be served.
 - b. How will the Core Curriculum Content Standards be addressed?
 - c. How does this program address least restrictive environment?
 - d. What opportunities will be available for interaction with non-disabled peers?
 - e. State the number of professional and paraprofessional staff. For paraprofessional staff submit the locally developed job description and standards for approval (N.J.A.C. 6:11-4.6(c)).

To Eliminate a Program/Service

1. Provide a rationale for eliminating the program/service.
2. If the elimination of the special education program/service will result in a change to one or more students' current IEP(s), describe how the students' needs will be met.

 I assure that the attached proposal to establish a new program/service is in accordance with New Jersey Administrative Code (N.J.A.C.) 6A:14, Special Education and N.J.A.C. 6A:26, Educational Facilities. (Attach the Board Resolution approving the establishment of the new program.)

Board Approval Date: _____ Signed: *Paul J. Jettan*
 (Chief School Administrator)

 I assure that any change in a student's program/placement necessitated by eliminating the special education program/service described in the attached proposal will be implemented in accordance with N.J.A.C. 6A:14, Special Education. (Attach the Board Resolution approving the elimination of the program/service.)

Board Approval Date: _____ Signed: _____
 (Chief School Administrator)

Approved _____ Denied _____
Signed: _____ Date _____ (County Supervisor of Child Study)

Establish a New Preschool Disabled Class Program

2014 Only

Due to an increase in enrollment of our preschool population within the Fort Lee Public School District the administration is expanding upon our preschool program. We are looking to temporarily place students from March – June, 2014 within School 1.

As per N.J.A.C. 6A: Chapter 14 Special Education, 4.7 The district is looking to enroll up to eight students in the class setting. There will be one teacher and a minimum of one instructional assistant.

The new preschool class will continue to implement the Creative Curriculum as a framework. In addition, we will follow the Preschool Standards to meet the needs of the student population. All students will have their related services as per their individual education plan.

Students will be provided with the least restrictive environment by being educated in their neighborhood elementary school with students who are not disabled. All placements will be identified based upon student need.

This is a temporary placement for the program until another placement is determined. At this time, a large influx of students are being referred to the public school district from Early Intervention and require immediate placement. (N.J.A.C. 6A : Chapter 14 Special Education 3.3 2).

PURCHASE OF SECURITY CAMERA SYSTEM

WHEREAS, there is a need for improved security on the fields and playgrounds of Schools #1, 2, 3, 4 and the Lewis F. Cole Middle School, and

WHEREAS, Millennium Communications Group, Inc. has submitted a proposal dated March 26, 2014 in the total amount of \$74,574.69 to provide Security Surveillance Cameras at each of the above named school locations, and

WHEREAS, the proposal is based on a Federal GSA bid contract #GS-35F0220R and NJWSCA 83083/75580 bid contract, and

NOW, THEREFORE, BE IT RESOLVED, that the purchase and installation of Security Surveillance Cameras as per proposal in the amount of \$74,574.69 be approved.

DATED: March 31, 2014
ATTACHMENT

Motion by: Mrs. Holly Morell

Seconded by: Mrs. Esther Han Silver

Motion Passed

Motion Failed

ROLL CALL	AYES	NAYS	ABSENT	ABSTAINED
MRS. ESTHER HAN SILVER	X			
MRS. HOLLY MORELL	X			
MRS. CANDACE ROMBA	X			
MR. DAVID SARNOFF	X			
MR. PETER SUH	X			
MR. JOSEPH SURACE			X	
MR. JEFF WEINBERG			X	
MS. HELEN YOON			X	
MR. YUSANG PARK	X			



One point of contact.
Endless Possibilities.

SPIN #143007785
Federal GSA #GS-35F-0220R
NJ WSCA 83083 / 75580
HCESC TEC #06 / TEC #07

March 26, 2014

Fort Lee Public School District
2175 Lemoine Avenue
Fort Lee, NJ 07024
Attn: Mr. Jason Ruggiero

Re: Additional Security Surveillance Cameras

Dear Mr. Ruggiero:

On behalf of Millennium Communications Group Inc (MCG), I wish to thank you for extending us the opportunity to submit a comprehensive proposal for the Fort Lee Public School District. We are pleased to present Security Surveillance Cameras. Please review the below for further detail and pricing.

Software

- Furnish and Install Active Directory Server
 - 4 TB Drives for PTZ additional storage
- Furnish and Install (13) Camera Licenses
 - (13) SMA 1 Year Basic Warranty

School #1

- Furnish and Install (3) Axis Cameras
 - (2) Axis Q6045-E PTZ cameras mounted on corner of building to view field/parking lot
 - (1) Axis P3364-LVE to view field/playground
 - Associated hardware and corner brackets

School #2

- Furnish and Install (3) Axis Cameras
 - (2) Axis Q6045-E PTZ cameras mounted on corner of building to view field/parking lot
 - (1) Axis P3364-LVE to view field
 - Associated hardware and corner brackets

School #3

- Furnish and Install (3) Axis Cameras
 - (2) Axis Q6045-E PTZ cameras mounted on corner of building to view field/parking lot
 - (1) Axis P3364-LVE to view field
 - Associated hardware and corner brackets

School #4

- Furnish and Install (2) Axis Cameras
 - (2) Axis Q6045-E PTZ cameras mounted on corner of building to view field/parking lot
 - Associated hardware and corner brackets

Middle School

- Furnish and Install (3) Axis Cameras
 - (3) Axis Q6045-E PTZ cameras mounted on corner of building to view field/parking lot
 - Associated hardware and corner brackets

Project Total: \$74,574.69



*One point of contact.
Endless Possibilities.*

SPIN #143007785
Federal GSA #GS-35F-0220R
NJ WSCA 83083 / 75580
HCESC TEC #06 / TEC #07

Notes:

- *MCG assumes switch ports are available*
- *FLPS to provide IP Addresses for cameras*
- *FLPS to provide Rack space and patch panels*
- *Electrical Not Included*
- *All work to be completed during regular business hours*

Once again, MCG appreciates the opportunity to submit the proposals for this project and looks forward to a long-standing relationship with Fort Lee Public School District. If you have any questions or require further information, please don't hesitate to contact me by phone at (973) 929-2517 or by email at jmahadeo@millenniuminc.com.

Sincerely,

Janille Mahadeo
Account Manager

Millennium Communications Group Inc.
GSA Project Estimate: Fort Lee School Additional Cameras
Automatic 1 year warranty on equipment & workmanship

Estimate Number **GSA GS-35F-0220R**

Date: **3-26-14**

GSA Contract # **GS-35F0220R**

Individual Order
 Blanket Order

Schedule	Vendor	GSA#	SIN	Labor Cat./Part #	Description	GSA Unit Rate	Units	Extended Cost	GSA Cost	
Security Cameras										
70	Millennium	GSA GS-35F-0220R	132-8	SSS012	Installation and network and server configuration of Server Station. Includes network configuration. Hardware included.	\$ 5,034.68	1	\$ 5,034.68	\$ 5,034.68	
70	Millennium	GSA GS-35F-0220R	132-8	PAS-10-113	Furnish and Install cable assembly	\$ 599.96	1	\$ 599.96	\$ 599.96	
70	Millennium	GSA GS-35F-0220R	132-8	SSS013	Installation and network configuration of IP system.	\$ 550.68	13	\$ 7,158.84	\$ 7,158.84	
70	Millennium	GSA GS-35F-0220R	132-8	SSS009	Installation and network configuration of single camera license.	\$ 519.61	13	\$ 6,754.93	\$ 6,754.93	
70	Millennium	GSA GS-35F-0220R	132-8	SSS074	Installation and network configuration of I/O V/P dome camera Furnish and Install Indoor/Outdoor Vanda Proof Fixed Dome Camera Network synchronization included.	\$ 627.50	2	\$ 1,255.00	\$ 1,255.00	
70	Millennium	GSA GS-35F-0220R	132-8	SSS073	VP Outdoor Fixed Camera Housing Furnish and Install Vandal Proof Outdoor Fixed Housing w/ heater & blower. Must be purchased as part of a network system.	\$ 443.53	2	\$ 887.06	\$ 887.06	
70	Millennium	GSA GS-35F-0220R	132-8	SSS027	Installation and network configuration of VP Indoor PTZ Camera. Network synchronization included. Hardware included power supply included.	\$ 2,039.88	11	\$ 22,438.68	\$ 22,438.68	
70	Millennium	GSA GS-35F-0220R	132-8	SSS031	Corner Mount PTZ Furnish and Install PTZ camera corner mount bracket Must be purchased as part of a network system. Not sold separately.	\$ 168.06	11	\$ 1,848.66	\$ 1,848.66	
70	Millennium	GSA GS-35F-0220R	132-8	PAS-10-113	Furnish and Install cable assembly	\$ 599.96	13	\$ 7,799.48	\$ 7,799.48	
				LVC003	Category 6 UTP cable (Plenum) Furnish and Install a complete Category 6 UTP Communications Drop up to 300 feet	\$ 709.55	13	\$ 9,224.15	\$ 9,224.15	
70	Millennium	GS-35F-0220R	132-51	Labor	Project Management	\$ 161.16	32	\$ 5,157.12	\$ 5,157.12	
70	Millennium	GS-35F-0220R	132-51	Labor	Network Integrator	\$ 129.14	32	\$ 4,132.48	\$ 4,132.48	
70	Millennium	GS-35F-0220R	132-51	Labor	Fiber Optic Technician	\$ 113.64		\$ -	\$ -	
70	Millennium	GS-35F-0220R	132-51	Labor	Field Technicain	\$ 90.92		\$ -	\$ -	
70	Millennium	GS-35F-0220R	132-51	Labor	Instaialtion Specialist	\$ 90.92	24	\$ 2,182.08	\$ 2,182.08	
70	Millennium	GS-35F-0220R	132-51	Labor	Cad Designer	\$ 77.48		\$ -	\$ -	
								Total GSA Cost	\$ 74,473.12	
Open Market										
						Misc. consumables	\$ 101.57	1	\$ 101.57	\$ 101.57
								Total Open Market	\$ 101.57	\$ 101.57
								Project Total Cost	\$ 74,574.69	

AUTHORIZATION TO ADVERTISE FOR BIDS FOR MODULAR CLASSROOM UNITS

Motion to authorize the Business Administrator/Board Secretary to advertise for bids for **Modular Classroom Units**.

Dates for advertising and acceptance of bids to be determined by the Business Administrator/Board Secretary.

DATED: March 31, 2014

Motion by: Mrs. Holly Morell

Seconded by: Mrs. Esther Han Silver

Motion Passed

Motion Failed

ROLL CALL	AYES	NAYS	ABSENT	ABSTAINED
MRS. ESTHER HAN SILVER	X			
MRS. HOLLY MORELL	X			
MRS. CANDACE ROMBA	X			
MR. DAVID SARNOFF	X			
MR. PETER SUH	X			
MR. JOSEPH SURACE			X	
MR. JEFF WEINBERG			X	
MS. HELEN YOON			X	
MR. YUSANG PARK	X			